

NOTES: MATERIAL & FINISH

△1.INSULATOR: HIGH-TEMP THERMOPLASTIC, UL94V-0
COLOR: NATURAL OR BLACK

△2.CONTACT: COPPER ALLOY
PLATING: CONTACT AREA GOLD FLASH AND SOLDER AREA TIN
OR GOLD FLASH OVERALL NICKEL UNDER PLATED

△△△3.ORDER INFORMATION: 3753K -X XX X-00,20,40 X

ENTERY INDUSTRIAL CO., LTD.
JAN - 9. 2015
R&D D.C.C. ISSUED

PACKING: R: PLASTIC CARRIER
E: TUBE
D: VACUUM ADN HUMIDITY LABEL △
L: PAPER CARRIER △

△ TYPE: 00: HS COLOR NA
20: HS COLOR BK
40: HS COLOR NA/PACKING REVERSE

N: STANDARD

△Y: PRINTING DATE CODE

PIN NO.

PLATING: E: TIN

△ Q: MATTE-TIN

△△ F: CONTACT GOLD-FLASH, FITTING NAIL TIN

△ U: CONTACT GOLD-FLASH, FITTING NAIL GOLD FLASH

△ B: CONTACT AREA GOLD FLASH, SOLDER AREA TIN

△△ J: 10u" GOLD

△ H: 15u" GOLD

△△ K: CONTACT AREA 30u"(MIN) GOLD, OTHER AREA
GOLD FLASH, FITTING NAIL 100u"~160u" TIN

△3753K: 1.0 WIRE TO BOARD SMT R/A DUAL ROW (HALOGEN FREE)

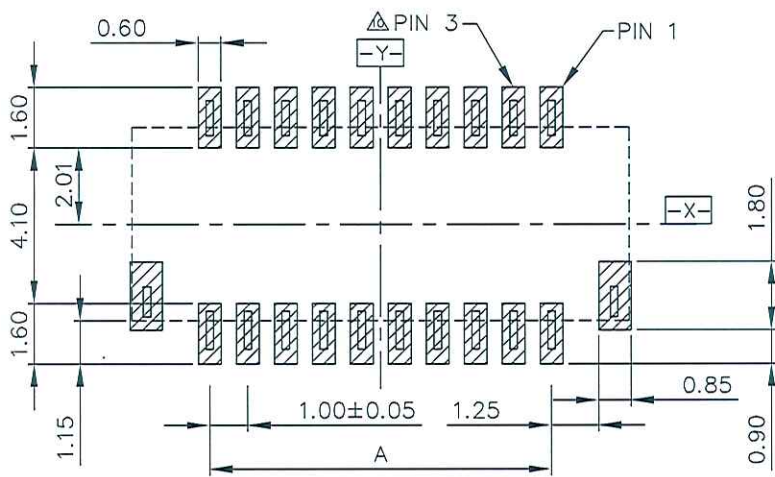
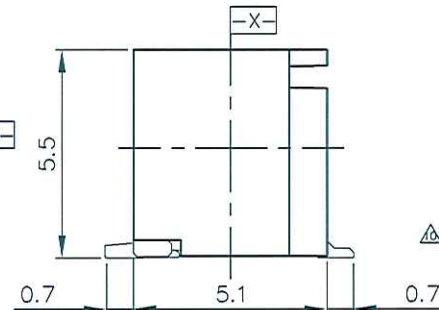
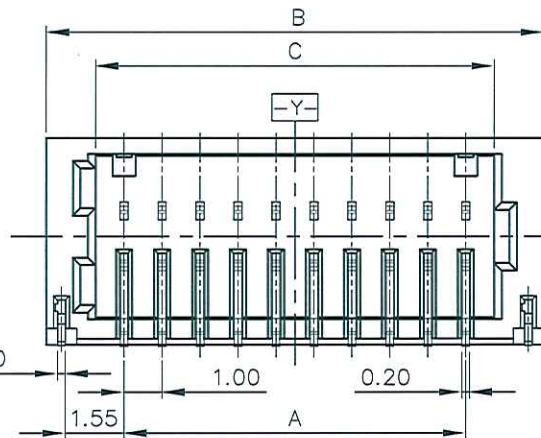
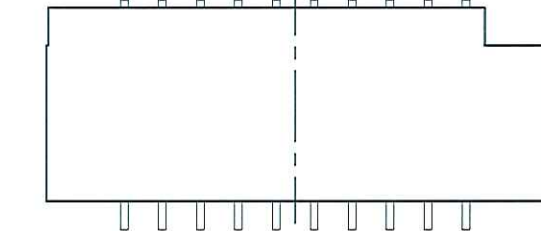

PC BOARD LAYOUT
TOLERANCES: ±0.1

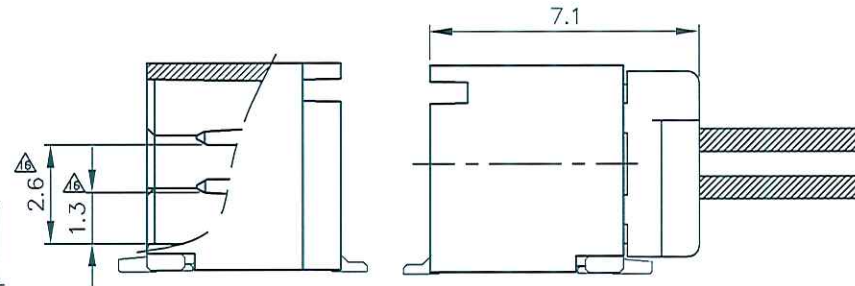

PIN NO.	A	B	C
△ 010	4.0	8.1	5.5
△ 012	5.0	9.1	6.5
△ 016	7.0	11.1	8.5
△ 018	8.0	12.1	9.5
020	9.0	13.1	10.5
030	14.0	18.1	15.5
040	19.0	23.1	20.5
050	24.0	28.1	25.5
060	29.0	33.1	30.5

CUSTOMER E&T 恩得利工業股份有限公司
ENTERY INDUSTRIAL CO., LTD.

DRAWN: John OCT-29-2004
CHECKED: [Signature]
APPROVED: [Signature] 1/8
SHEET 1/1

GENERAL TOLERANCE UNLESS OTHERWISE SPECIFIED
X.X ±0.30
X.XX ±0.20
X.XXX ±0.10
ANG. ±0°30'

PART NO. △△△△△
3753K-XXXX-00,20,40X

TITLE:
1.0 WTB SMT R/A
TYPE DUAL ROW

UNIT	SCALE	SIZE	REV
MM	5:1	A4	V

△	REVISIONS	CHK	DATE
△	REN150102	Amy	01/08/15
△	RE2014010007	JOSH	04/01/14
△	RE201208014	Maz	12/25/12
△	RE201210002		
△	RE201210013	JIMMY	10/29/12
△	RE201209003		
△	REN120212	KAZ	02/21/12
△	REN111112	Juno	11/14/11