

NOTES: MATERIAL AND FINISH

- 1.INSULATOR: HIGH-TEMP THERMOPLASYIC, UL94V-0
COLOR:NATURE OR BLACK
- 2.CONTACT: COPPER ALLOY
- 3.PLATING: MATTE-TIN OR GOLD FLASH
OVERALL NICKEL UNDER FLASH
- 4.FITTING NAIL: COPPER ALLOY
- 5.PLATING: TIN OVER ALL NICKEL UNDER PLATED

ORDER INFORMATION: 3809K-X XX X-X0 X

PACKING: R: PLASTIC REEL
E: TUBE
L: PAPER REEL

TYPE
00: NATURE
20: BLACK
N: STANDARD
C: ADD CAP
M: ADD MYLAR△

PIN NO.
PLATED:
Q: MATTE-TIN
F: CONTACT GOLD FLASH
FITTING NAIL TIN

HALOGEN-FREE MATERIALS
1.25 WT B/H SMT V/T

ENTERY INDUSTRIAL CO., LTD.
OCT - 5. 2012
R&D D.C.C. ISSUED

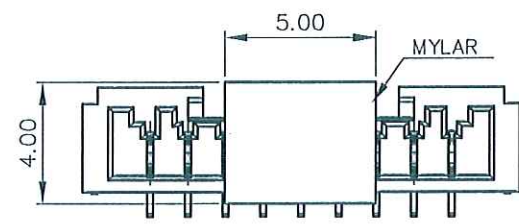
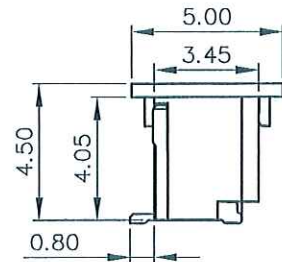
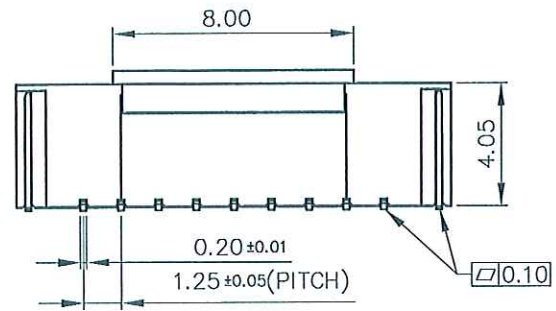
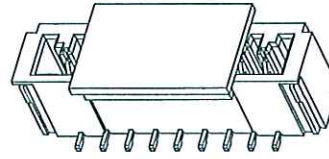
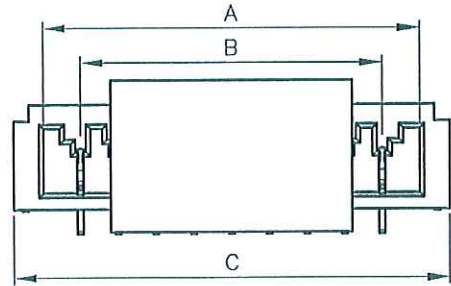

△3809K-XXXM-XOX: ADD MYLAR

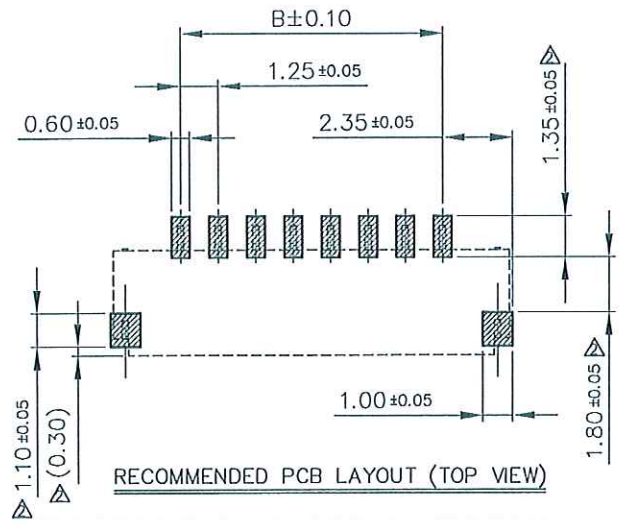

PIN	A	B	C
02	3.75	1.25	5.75
03	5.00	2.50	7.00
04	6.25	3.75	8.25
05	7.50	5.00	9.50
06	8.75	6.25	10.75
07	10.00	7.50	12.00
08	11.25	8.75	13.25
09	12.50	10.00	14.50
10	13.75	11.25	15.75
11	15.00	12.50	17.00
12	16.25	13.75	18.25
13	17.50	15.00	19.50
14	18.75	16.25	20.75
15	20.00	17.50	22.00



CUSTOMER		恩得利工業股份有限公司 ENTERY INDUSTRIAL CO., LTD.	
GENERAL TOLERANCE UNLESS OTHERWISE SPECIFIED X.X ±0.20 X.XX ±0.10 X.XXX ±0.05 ANG. ±1°		DRAWN <i>Kidd</i> JUL-08-2009 CHECKED APPROVED SHEET 1/1	PART NO. 3809K-XXXX-XOX TITLE: 1.25 PITCH WT B/H SMT V/T LOW INSERTION TYPE
△ RE201209007 JUNO 09/25/12' △ REN101111 JIMMY 11/11/07 SER REVISIONS CHK DATE	UNIT MM SCALE 4:1 SIZE A4 REV C		