

- NOTES: MATERIAL & FINISH  
 1. HOUSING: HIGH-TEMP THERMOPLASTIC UL94V-0  
 COLOR: BLACK  
 2. ACTUATOR: HIGH-TEMP THERMOPLASTIC UL94V-0  
 COLOR: WHITE  
 3. TERMINAL: COPPER ALLOY, t: 0.15mm  
 PLATING: GOLD FLASH OR TIN OR MATTE-TIN PLATED  
 4. FITTING NAIL: COPPER ALLOY, t: 0.20mm  
 PLATING: 100~160u" TIN PLATED OVERALL,  
 50~100u" NICKEL UNDERPLATED.

PIN NO.	E
04~30 PIN	6.00
31~60 PIN	12.00



5. ORDER INFORMATION: 6705K-X XX X-00,20,30,40X  
 N: STANDARD  
 M: MYLAR  
 PIN NO.  
 PLATING: E: CONTACT: 100~160u" TIN PLATED OVERALL,  
 50~100u" NICKEL UNDERPLATED.  
 F: CONTACT: GOLD FLASH PLATED OVERALL,  
 Q: CONTACT: 100~160u" MATTE-TIN PLATED OVERALL,  
 50~100u" NICKEL UNDERPLATED.  
 Y: CONTACT AND SOLDER: GOLD FLASH PLATED OVERALL,  
 50~100u" NICKEL UNDERPLATED.  
 W: CONTACT: GOLD FLASH PLATED OVERALL,  
 SOLDER: MATTE-TIN 100u"~160u",  
 M: CONTACT AREA 5u" GOLD  
 SOLDER AREA GOLD FLASH

ENTERY INDUSTRIAL CO., LTD.  
 JUN 17, 2015  
 R&D D.C.C. ISSUED

PIN	A	B	C	D
04	6.1	1.5	2.55	4.7
05	6.6	2.0	3.05	5.2
06	7.1	2.5	3.55	5.7
07	7.6	3.0	4.05	6.2
08	8.1	3.5	4.55	6.7
09	8.6	4.0	5.05	7.2
10	9.1	4.5	5.55	7.7
11	9.6	5.0	6.05	8.2
12	10.1	5.5	6.55	8.7
13	10.6	6.0	7.05	9.2
14	11.1	6.5	7.55	9.7
15	11.6	7.0	8.05	10.2
16	12.1	7.5	8.55	10.7
17	12.6	8.0	9.05	11.2
18	13.1	8.5	9.55	11.7
19	13.6	9.0	10.05	12.2
20	14.1	9.5	10.55	12.7
21	14.6	10.0	11.05	13.2
22	15.1	10.5	11.55	13.7
23	15.6	11.0	12.05	14.2
24	16.1	11.5	12.55	14.7
25	16.6	12.0	13.05	15.2
26	17.1	12.5	13.55	15.7
27	17.6	13.0	14.05	16.2
28	18.1	13.5	14.55	16.7
29	18.6	14.0	15.05	17.2
30	19.1	14.5	15.55	17.7
31	19.6	15.0	16.05	18.2
32	20.1	15.5	16.55	18.7
33	20.6	16.0	17.05	19.2
34	21.1	16.5	17.55	19.7
35	21.6	17.0	18.05	20.2
36	22.1	17.5	18.55	20.7
37	22.6	18.0	19.05	21.2
38	23.1	18.5	19.55	21.7
39	23.6	19.0	20.05	22.2
40	24.1	19.5	20.55	22.7
41	24.6	20.0	21.05	23.2
42	25.1	20.5	21.55	23.7
43	25.6	21.0	22.05	24.2
44	26.1	21.5	22.55	24.7
45	26.6	22.0	23.05	25.2
46	27.1	22.5	23.55	25.7
47	27.6	23.0	24.05	26.2
48	28.1	23.5	24.55	26.7
49	28.6	24.0	25.05	27.2
50	29.1	24.5	25.55	27.7
51	29.6	25.0	26.05	28.2
52	30.1	25.5	26.55	28.7
53	30.6	26.0	27.05	29.2
54	31.1	26.5	27.55	29.7
55	31.6	27.0	28.05	30.2
56	32.1	27.5	28.55	30.7
57	32.6	28.0	29.05	31.2
58	33.1	28.5	29.55	31.7
59	33.6	29.0	30.05	32.2
60	34.1	29.5	30.55	32.7

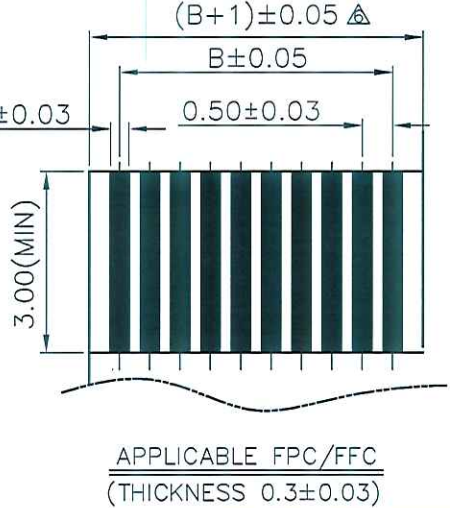
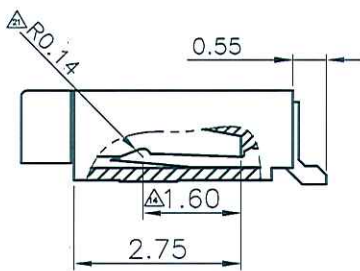
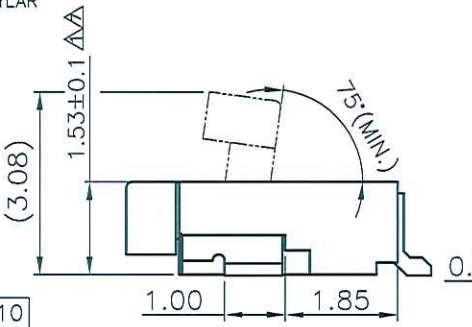
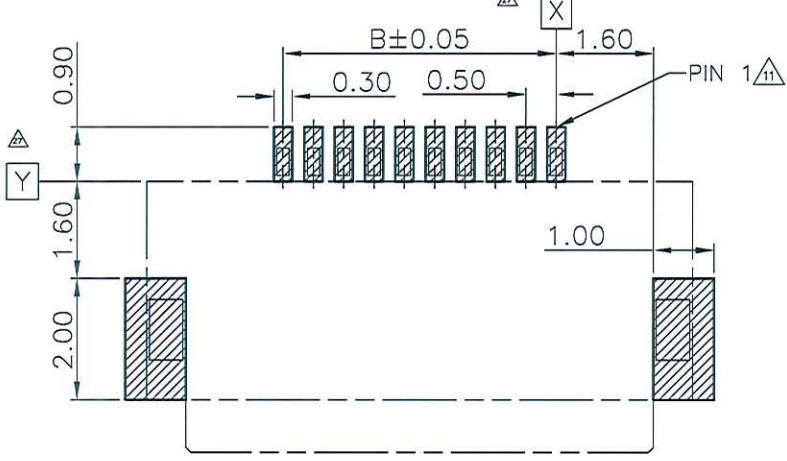
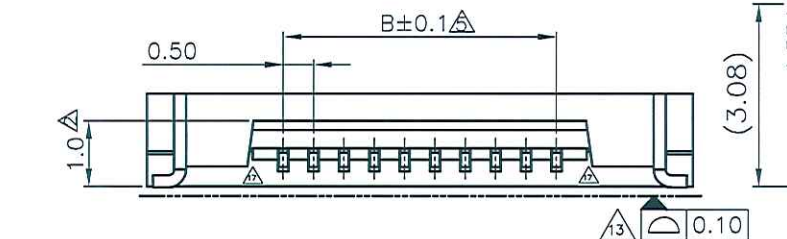
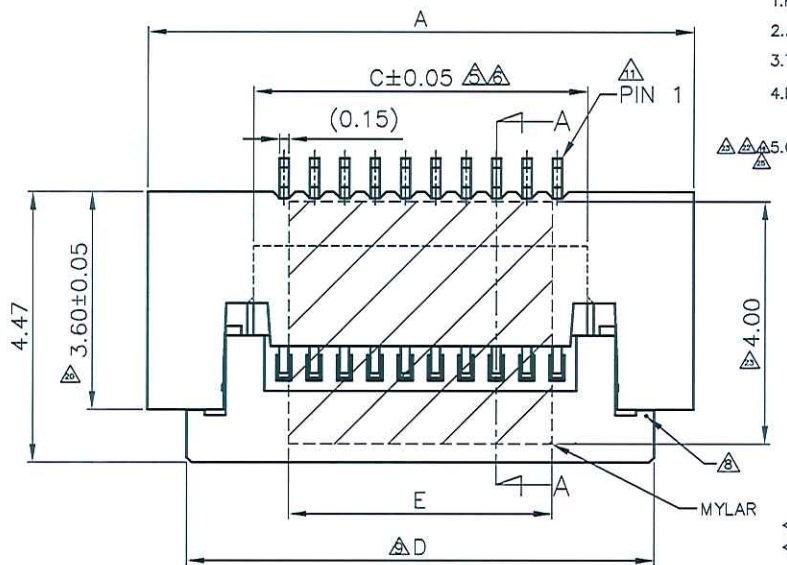

PCB LAYOUT  
 TOLERANCE : ±0.05

CABLE INSERT DIM.  
 SECTION A-A

APPLICABLE FPC/FFC  
 (THICKNESS 0.3±0.03)

SER	REVISIONS	CHK	DATE
△	RE201304010	Ceres	06/16/15
△	RE201503005	Juno	04/15/15
△	RE201401007	Juno	03/19/14
△	REN140113	Juno	01/27/14
△	RE201212010	MAX	12/20/12
△	RE201208014	JIMMY	12/20/12
△	RE201210002		

CUSTOMER

恩得利工業股份有限公司  
 E&T  
 ENTERY INDUSTRIAL CO., LTD.

GENERAL TOLERANCE  
 UNLESS OTHERWISE SPECIFIED  
 X.X ±0.25  
 X.XX ±0.20  
 X.XXX  
 ANG. ±0.30'

DRAWN  
 Joan OCT-28-2004  
 CHECKED  
 APPROVED  
 SHEET 1/1

PART NO. △△△△△  
 6705K-XXXX-00,20,30,40X  
 TITLE:  
 0.5 ZIF FPC R/A B/C

UNIT MM SCALE 8:1 SIZE A4 REV AE